

**Technical and price proposal**

---

Project : Takamaz ESL-10

---

Dear Client,

Thank you for your interest in our products. With reference to your inquiry we are pleased to present the following trade proposal.

According to the assumption - *"quality and components from Japan at the best prices"* - we would like to offer you the TAKAMAZ ESL-10 machine:

Machine	:	<b>CNC TURNING LATHE</b>
Product	:	<b>TAKAMAZ</b>
Model	:	<b>ESL-10</b>
Control	:	<b>FANUC 0i-TF</b>

## Takamaz ESL-10



The photo presents the TAKAMAZ ESL-10 machine

## MACHINE SPECIFICATIONS

Maximum turning diameter	∅ 180 mm
Maximum turning length	190 mm
Stroke of X axis	120 mm
Stroke of Z axis	230 mm
Rapid feed of X axis	12 m/min
Rapid feed of Z axis	18 m/min
Spindle drive power	5.5 / 3.7 kW
Drive power of X axis	AC 0.75 kW
Drive power of Z axis	AC 1.2 kW
Coolant pump	AC 0.25 kW
Hydraulic pump	AC 0.75 kW
L x W x H	1,450 x 1,295 x 1,650 mm
Weight	1.67 t
Current consumption	13 kVA

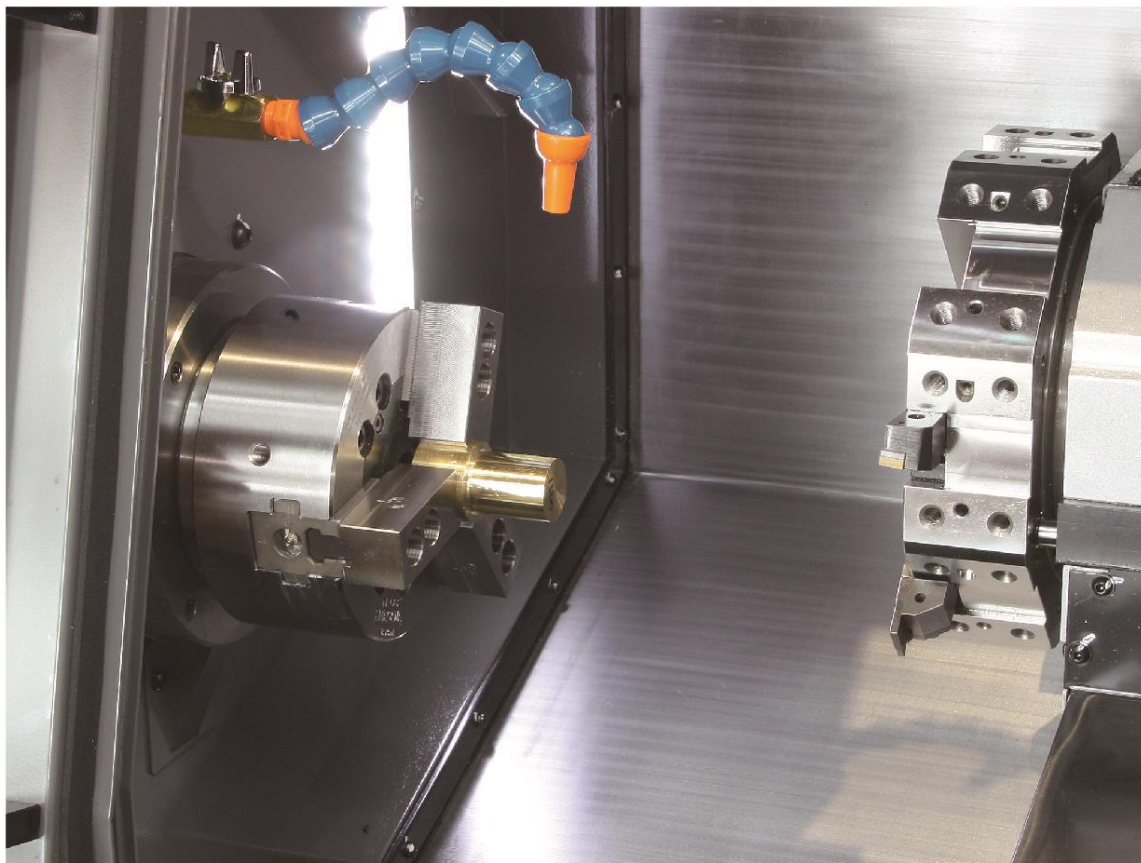

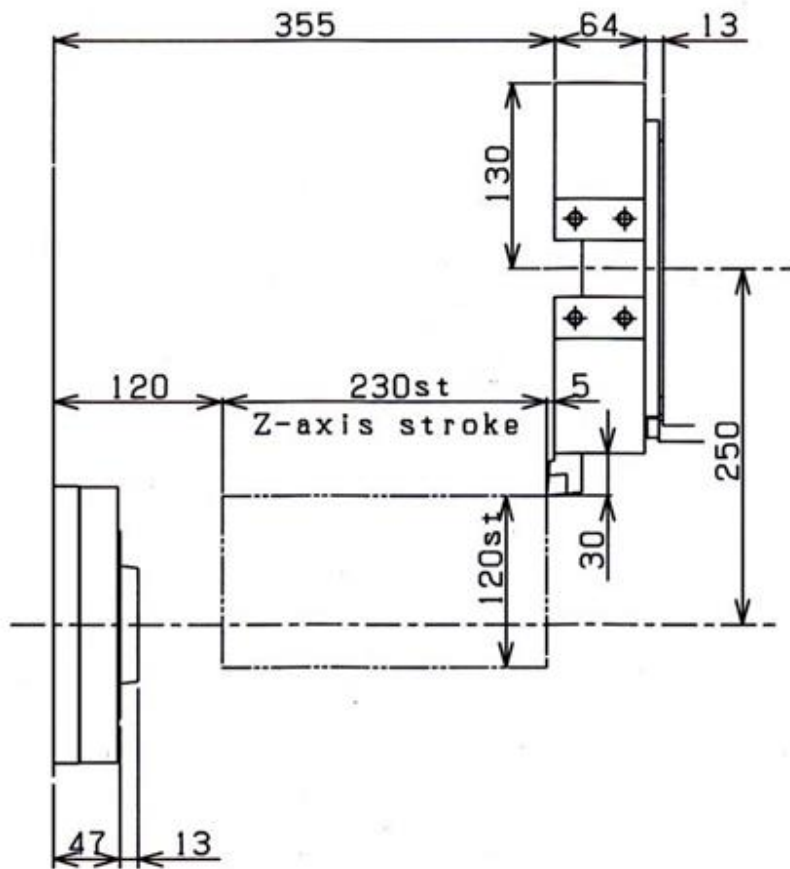

<b>Spindle</b>	
Spindle drive power	5.5 / 3.7 kW
Maximum spindle speed	4,500 min <sup>-1</sup>
Maximum torque	46.7 Nm
Spindle type	A2-5
Spindle bearing diameter	∅ 75 mm
Spindle hole	∅ 46 mm
Maximum diameter of bar (for <b>ESL-10 B version</b> )	∅ 35 mm

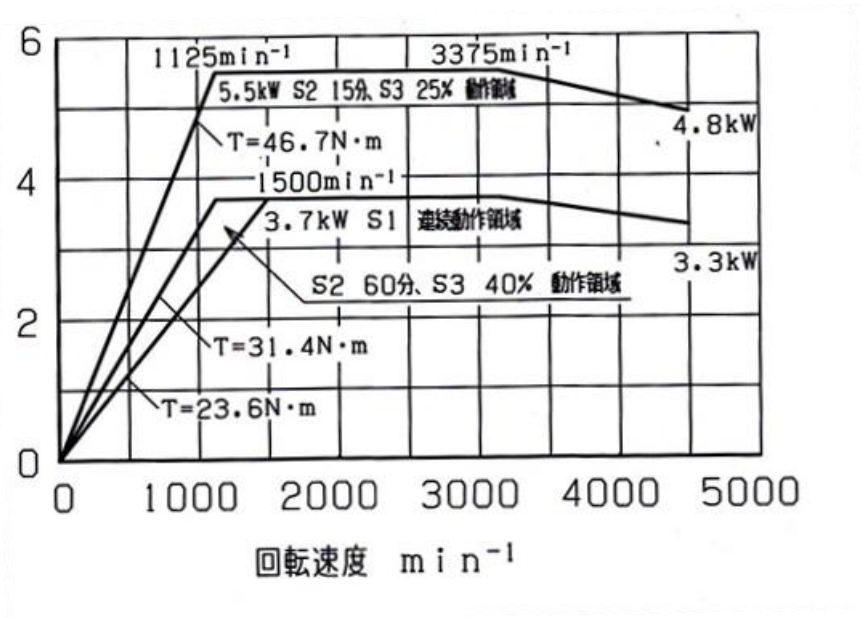

Turret tool	
Number of turrets	1
Type	Direct mounting
Number of tools in turret	8
Tool size	20 x 20 mm
Maximum boring bar diameter	φ 25 mm

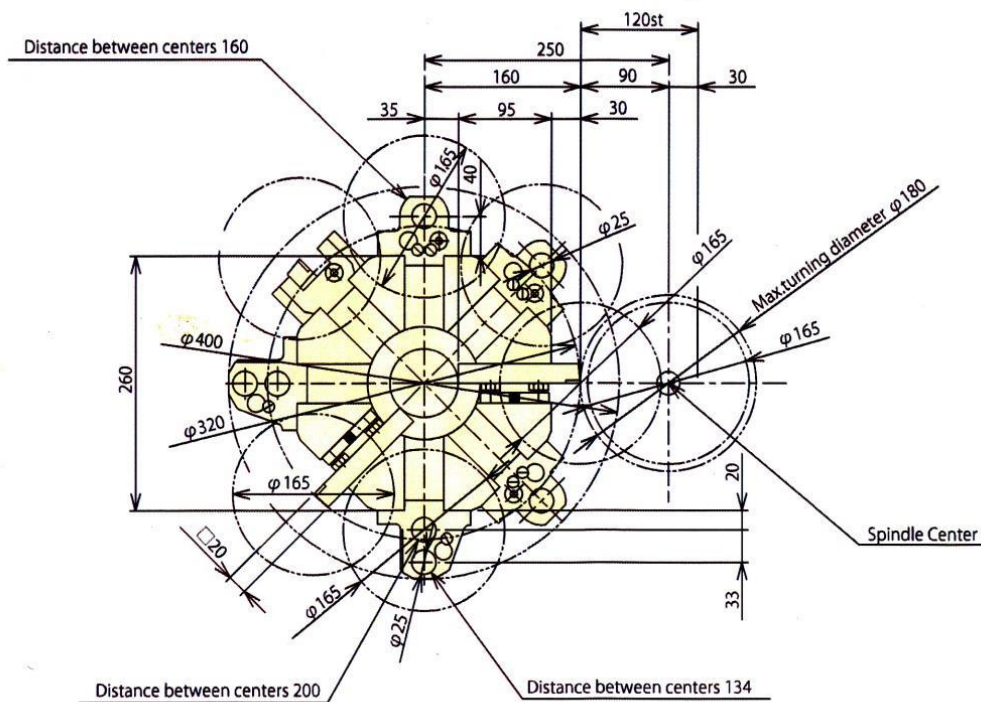

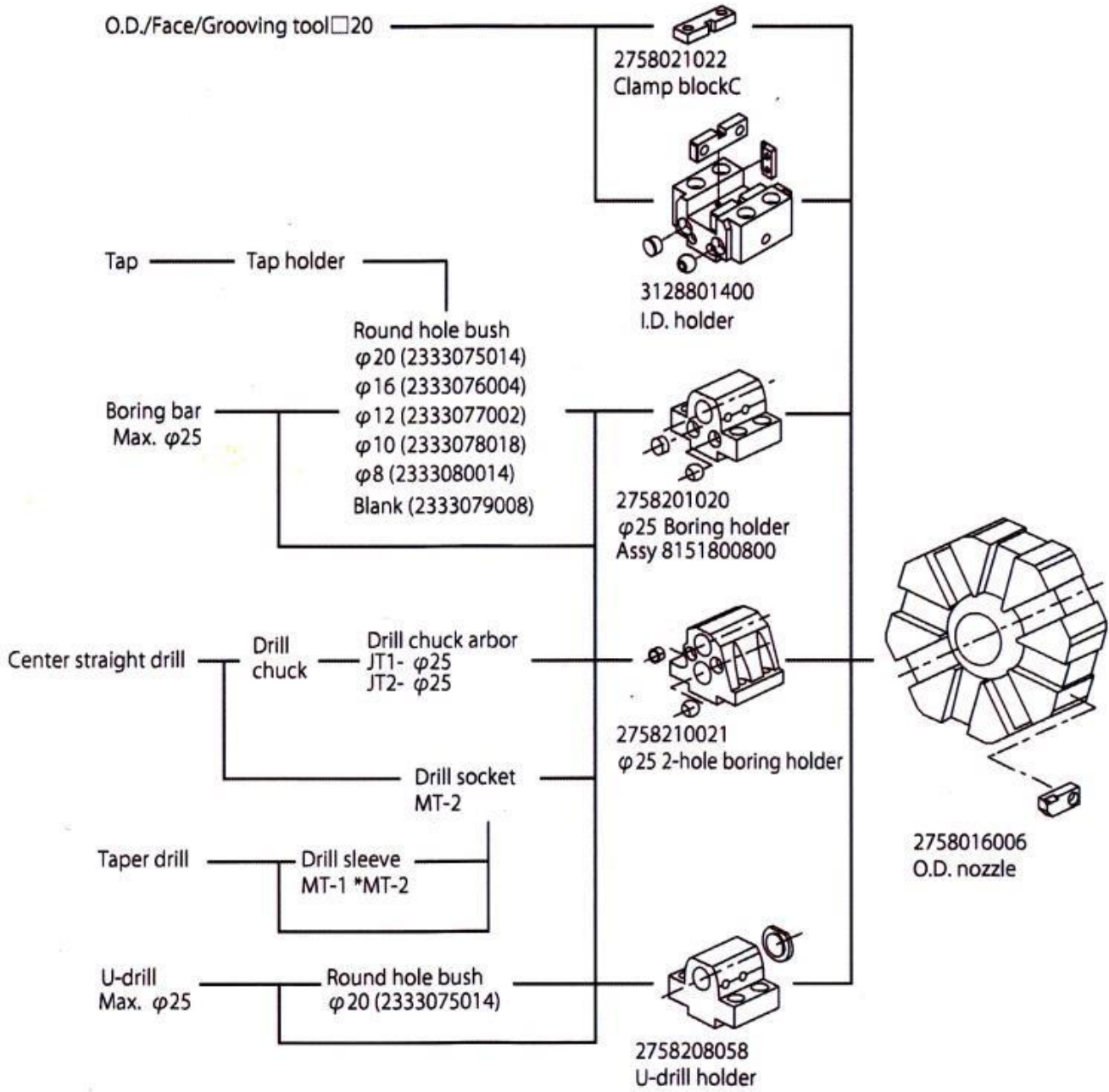



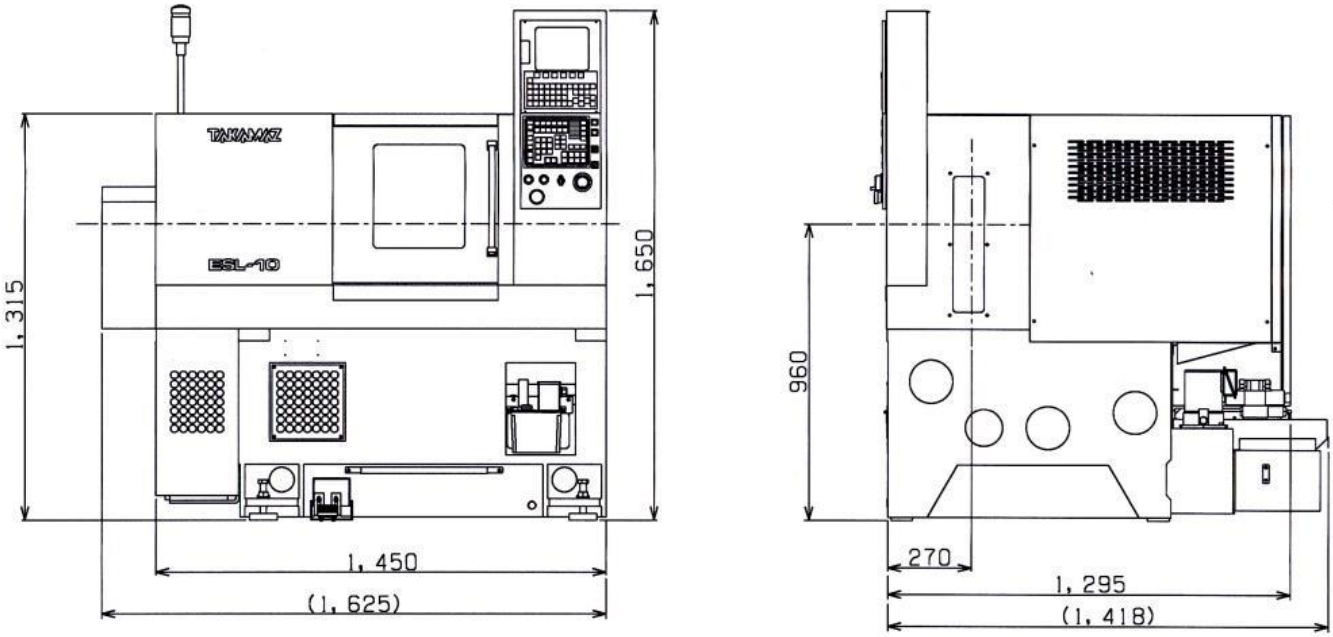

The figure shows ESL-10 without a chip conveyor and a transformer

## Extensive basic equipment of the machine

- **Compact design.** The basic machine, electric control cabinet, cooling system, CNC control, control panel, and the workroom housing form a coherent unit on a very small area. Ergonomics, low center of gravity, operator-friendly and environmentally-friendly conditions, as well as the highest precision, and durability were taken into account when designing the unit.
- **The machine bed** has a strong rib structure. Diagonal reinforcing ribs prevent vibrations during the machining process and thermal deformations. The results include high rigidity and the best vibration damping properties.
- Standard Tool Holders
  - x8 sets of Clamp Block #2758021022
  - x2 sets of Boring Holder #2758201020
- X and Z axes have been equipped with perfectly sized, hardened and polished linear roller guides (made in Japan).
- **Ball screws** (made in Japan) are installed in all axes.
- **The spindle** has best-in-class bearings (made in Japan), and it has been designed to absorb forces radially and axially.
- **The optimum chip drop and easily accessible workspace** have been achieved by placing the spindle directly above the chip container.
- **Hydraulic pump unit**
- **Hydraulic cylinder for the holder**  
ESL-10 B with hollow cylinder SMW VNK70-37
- **FANUC 0i-TF control** with an 8-inch LCD screen.
- **Standard coolant pump**
- **Levelling plates**
- **Electrical control cabinet**, fan cooled.
- **CE conformity**



**Select the equipment for your machine!**

<b>ESL-10 B</b> Diameter of bar 35 mm in tow bar, bar length max. 800 mm Warranty 12 months	44.500,-€	
<b>Recommended options</b>		
Transformer	800,-€	
Chip conveyer	2.750,-€	
Transport (Depend on country of delivery, please ask)		
Installation	500,-€	
Training	800,-€	
<b>Chuck</b>		
Collet chuck SMW KSZMB 40 A5 (173E)	1.300,-€	
Solid chuck Kitagawa N06 A5	1.545,-€	
Hollow chuck SMW BHD 165 A5	2.095,-€	
Hollow chuck Kitagawa B 206 A5	1.995,-€	
<b>Additional options</b>		
Parts-catcher (You can see photo of parts catcher in website Gallery)	3.950,-€	
Warranty extension Takamaz to a total of 24 months	1.000,-€	
Warranty extension Fanuc to a total of 24 months	1.000,-€	
Additional facing tool	345,- €/St.	
Additional boring holder	395,- €/St.	
Additional double boring holder	475,- €/St.	
Additional U-boring holder	465,- €/St.	

(All prices excluding VAT)

## Terms of sale and payment

### **Cost valuation**

FCA Incoterms 2010 seaport of Antwerp or one of our warehouses.  
All prices are net prices exclusive of VAT.

### **Delivery time**

ESL-10 B Delivery time from June 2016.

### **Delivery**

Delivery of the machine is carried out in accordance with the general terms and conditions (GTC) of our sales network

### **Terms of payment**

to be discussed

### **Technical data**

The presented technical data is not binding and must be confirmed if an order is made. The manufacturer reserves the right to make any changes in the data.

### **Warranty**

Under the general terms and conditions the warranty period begins when the machine is collected by the buyer.

The warranty does not include wear parts and damage caused by incorrect machine operation.  
FANUC warranty is not include in machine price.

### **Proposal validity**

This proposal is not binding. The prices shall be valid for a period of four weeks from the date of issue.

### **Other**

Unless otherwise specified the general terms and conditions shall apply.

Additional arrangements must be made in writing.

## Your partner in machining and automation solutions

### "Efficient production at our clients' premises is our top priority!"

The production technology faces different challenges. New materials and the highest quality standards generate stricter and stricter requirements for modern production techniques. Globalization of markets and shortening delivery times increase the pressure on costs and flexibility in production. Our sales network and its entire team face these challenges and implement innovative solutions.

#### **System integration**

With our extensive expertise in the field of machining technology from the measurement technique to complex automation we can develop and implement individual and technically advanced production solutions together with our clients.

Our sales network develops the concept of production that is based on a thorough analysis of your requirements and technical capabilities.

#### **Balanced automation**

We also offer extensive consulting services in terms of automation. What was an innovative technological requirement yesterday may already be outdated today. Not everything that looks like the latest technology would be the best solution for your individual production concepts. Automation must be matched to your requirements. Our sales network automates not only machines of its suppliers but also machines and production equipment from any other manufacturers.

#### **Our services:**

- ✓ Interdisciplinary process development
- ✓ Automation and combining of processes
- ✓ Delivery of complete and individual production systems
- ✓ Support in line with the "comprehensive service from a single supplier/manufacturer" principle
- ✓ Comprehensive consulting and after-sales services